



DRAWINGS, SCHEMATICS, & PART NUMBERS

Section

9

Transition Box Bulkhead Cable & Hose Termination [B-10343]	9.3
Hydraulic Line Connections	9.4
ESP Optic and Bay Sign Detail	9.5
ESP Sensor Wiring Schematic [D-10470]	9.6
ESP Optic Receiver Assembly [B-12580]	9.7
ESP Optic Transmitter Assembly [B-12581]	9.8
ESP Ultra Sonic Assembly [B-12473]	9.9
Bay Layouts	
Van [F-10312] Right Hand	9.11
Van [F-10312] Left Hand	9.12
Car [F-10311] Right Hand	9.13
Car [F-10311] Left Hand	9.14
XP Bay Layout	9.15
Equipment Room Layout	9.16
Equipment Room Details	9.17
Electrical Schematics	9.18-9.21
Water & Chemical Schematic [D-10847]	9.22
Hydraulic Schematic [D-10850]	9.23
Air Schematic [D-10848]	9.24
Winterization System Schematic [D-10845, D-10846]	9.25-9.26
Bridge Assembly [B-9500]	9.27-9.29
Trolley Assembly [B-9687]	9.30
Wand Assembly [B-9688]	9.31
Wand Assembly Van [B-10570]	9.32
Knuckle Assembly [B-10254]	9.33
In-Bay Equipment [B-9827]	9.34
Transition Box [B-9734]	9.35
V-Trap Treadle Switch [F-8947]	9.36
Pump Stand Assembly 230/460VAC [B-10589]	9.37



Tank Assembly, Pump Stand [B-9845]	9.38
Outlet Bulkhead / Regulator Panel Assembly [B-10860]	9.39
Pump Stand Assembly w/Accumulator [B-10931].....	9.40
Hydraulic Power Unit Assembly 240VAC [B-10486]	9.41
Heated Presoak Option Natural Gas [F-10319]	9.42
Heated Presoak Option Electric 230VAC [F-10320]	9.43
Winterization System Natural Gas [F-10324].....	9.44
Winterization System Electric 230VAC [F-10326].....	9.45
Winterization System Heat Exchanger [F-10325]	9.46
Heated Presoak Schematic 575VAC [D-11115]	9.47
Heated Presoak Schematic 230VAC [D-11116]	9.48
Float Switch Tube Assembly [B-11318]	9.49
Fitting Kit Pump Stand [B-11576].....	9.50
2-Station LED Sign [F-12045]	9.51
3-Station LED Sign [F-12044]	9.52

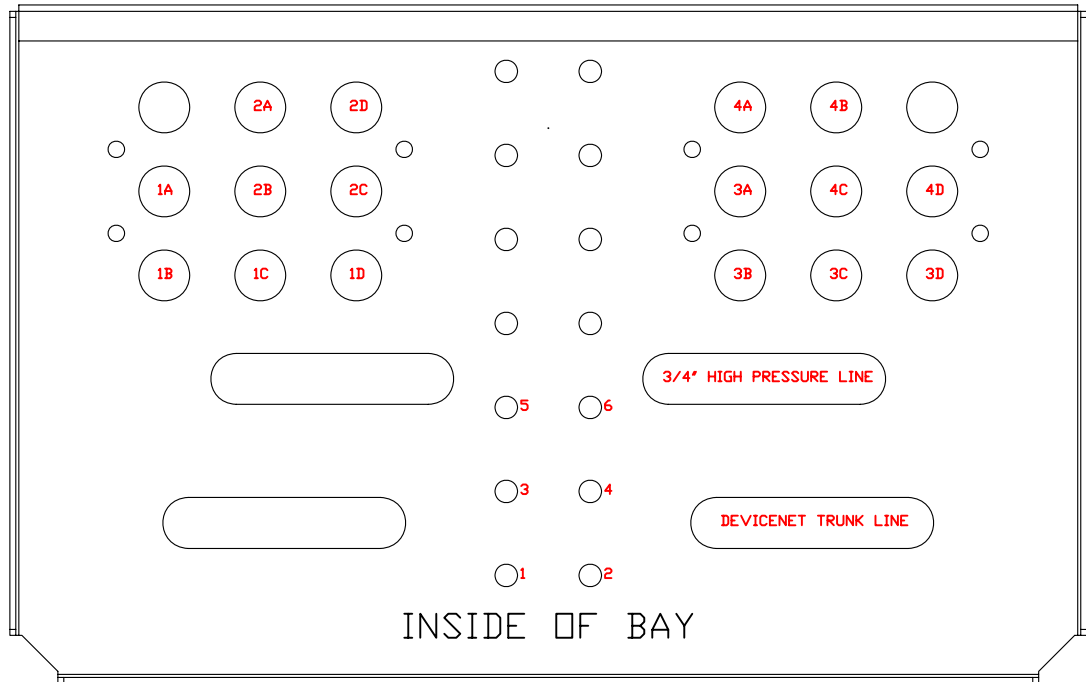
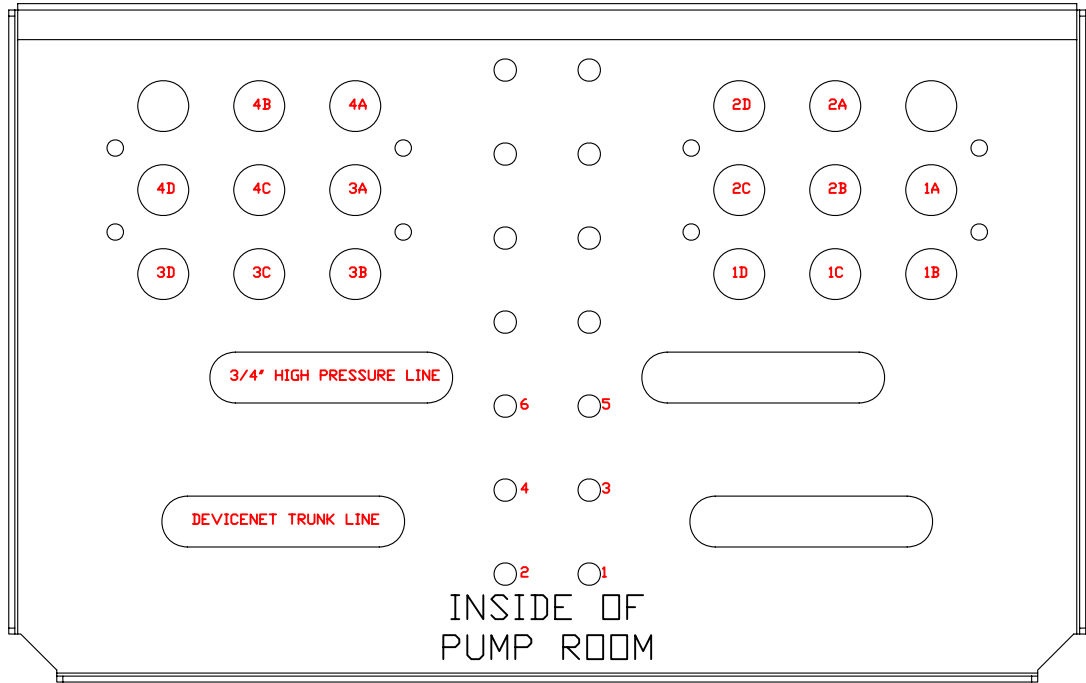

TRANSITION BOX SPLICE

NO.	REVISIONS	DATE	BY

7500 ORDER #		COMPONENT 1, 1995	DIMENSIONS IN ()		UNLESS OTHERWISE NOTED BREAK ALL SHARP EDGES AND CORNERS 90° AND DRAWING SYMBOLS FINISH ALL OVER		190 EAST 25th STREET DULLES, VA 20146 TEL: (703) 271-1955 FAX: (703) 271-2725 WWW.SCSYSTEMS.COM		
START DATE:	END DATE:	DATE:	DATE:	DATE:	DATE:	DATE:	DATE:	DATE:	
QUANTITY:		ALL RIGHTS RESERVED		PROPERTY NOTICE		THIS DOCUMENT CONTAINS CONFIDENTIAL AND TRADE SECRET INFORMATION. IS THE PROPERTY OF SCS SYSTEMS, INC. AND IS TO BE USED ONLY FOR THE PROJECT AND SITE SPECIFICALLY IDENTIFIED IN THIS DOCUMENT. IT IS TO BE DESTROYED AND NOT REPRODUCED OR TRANSMITTED IN ANY FORM OR BY ANY MEANS, ELECTRONIC OR MECHANICAL, INCLUDING PHOTOCOPYING, RECORDING, OR BY ANY INFORMATION STORAGE AND RETRIEVAL SYSTEM, WITHOUT THE WRITTEN PERMISSION OF SCS SYSTEMS, INC. ANY UNAUTHORIZED USE OF THIS DOCUMENT IS PROHIBITED AND WILL BE PROSECUTED TO THE FULL EXTENT OF THE LAW.		SCALE: 1" = 1'	
APPROVALS:		STANDARDS:		TOLERANCES:		FINISHES:		DRAWN BY: JJJ	
DESIGNED:	CHECKED:	APPROVED:	DATE:	XX	± 0.003			DATE: 09/22/2005	
				XX	± 0.005			REV: N/A	
				XXX	± 0.010				
					± 0.015				
					± 0.020				
					± 0.030				
					± 0.040				
					± 0.050				
					± 0.060				
					± 0.070				
					± 0.080				
					± 0.090				
					± 0.100				
					± 0.125				
					± 0.150				
					± 0.175				
					± 0.200				
					± 0.250				
					± 0.300				
					± 0.350				
					± 0.400				
					± 0.450				
					± 0.500				
					± 0.550				
					± 0.600				
					± 0.650				
					± 0.700				
					± 0.750				
					± 0.800				
					± 0.850				
					± 0.900				
					± 0.950				
					± 1.000				
					± 1.050				
					± 1.100				
					± 1.150				
					± 1.200				
					± 1.250				
					± 1.300				
					± 1.350				
					± 1.400				
					± 1.450				
					± 1.500				
					± 1.550				
					± 1.600				
					± 1.650				
					± 1.700				
					± 1.750				
					± 1.800				
					± 1.850				
					± 1.900				
					± 1.950				
					± 2.000				
					± 2.050				
					± 2.100				
					± 2.150				
					± 2.200				
					± 2.250				
					± 2.300				
					± 2.350				
					± 2.400				
					± 2.450				
					± 2.500				
					± 2.550				
					± 2.600				
					± 2.650				
					± 2.700				
					± 2.750				
					± 2.800				
					± 2.850				
					± 2.900				
					± 2.950				
					± 3.000				
					± 3.050				
					± 3.100				
					± 3.150				
					± 3.200				
					± 3.250				
					± 3.300				
					± 3.350				
					± 3.400				
					± 3.450				
					± 3.500				
					± 3.550				
					± 3.600				
					± 3.650				
					± 3.700				
					± 3.750				
					± 3.800				
					± 3.850				
					± 3.900				
					± 3.950				
					± 4.000				
					± 4.050				
					± 4.100				
					± 4.150				
					± 4.200				
					± 4.250				
					± 4.300				
					± 4.350				
					± 4.400				
					± 4.450				
					± 4.500				
					± 4.550				
					± 4.600				
					± 4.650				
					± 4.700				
					± 4.750				
					± 4.800				
					± 4.850				
					± 4.900				
					± 4.950				
					± 5.000				

NO	REVISION	DATE	APPROVAL

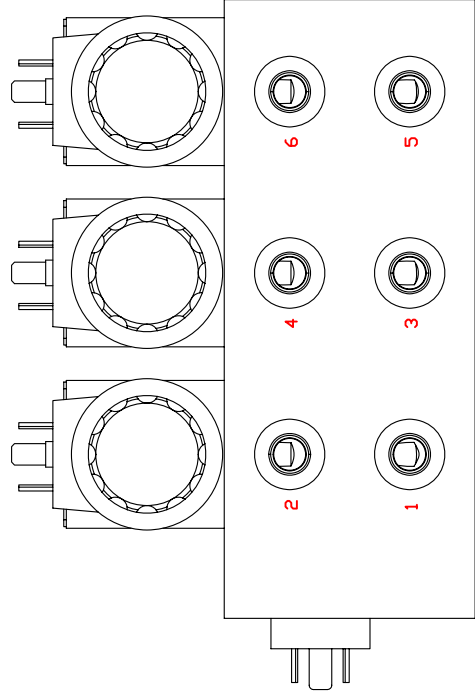

HYDRAULIC PUMP
MANIFOLD CONNECTIONS

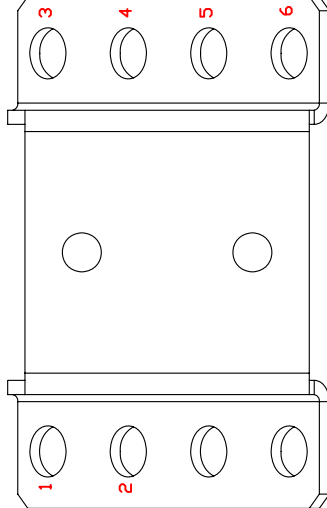

BRIDGE JUNCTION BOX
HYDRAULIC CONNECTIONS

1	HYDRAULIC HOSES
2	BRIDGE HYDRAULIC MOTOR EXTEND
3	BRIDGE HYDRAULIC MOTOR HOME
4	TROLLEY HYDRAULIC MOTOR EXTEND
5	TROLLEY HYDRAULIC MOTOR HOME
6	ADJUSTABLE WAND ROTATION ACCUATOR EXTEND (CW)
	ADJUSTABLE WAND ROTATION ACCUATOR RETRACT (CCW)

<p>TRUCK ORDER #</p> <p>START DATE: _____ END DATE: _____</p> <p>QUANTITY: _____ DATE: _____</p> <p>APPROVALS: _____</p> <p>DRAWN: _____</p> <p>CHECKED: _____</p> <p>RESP ENG: _____</p> <p>MFG ENG: _____</p> <p>QUAL ENG: _____</p>	<p>COMPONENT 3 1995 DASSI CAR WASH SYSTEMS ALL RIGHTS RESERVED</p> <p>STANDARD TOLERANCES XX = ± 0.003 XXX = ± 0.005 XXXX = ± 0.010 XXXXX = ± 0.015 FLATNESS = 0.004/FT</p> <p>FINISHES THE FINISH OR SURFACE OF THIS DRAWING OR A PRODUCT PRODUCED HEREFROM SHALL BE SUBJECT TO ALL APPLICABLE REGULATIONS AND OTHER APPLICABLE REGULATIONS, INCLUDING OR EXCEEDING:</p>	<p>DIMENSIONS IN 1 / 8 INCHES UNLESS NOTED OTHERWISE</p> <p>UNLESS OTHERWISE NOTED BREAK ALL SHARP EDGES AND CORNERS 1/8" AND 1/4" SURFACE FINISH ALL OVER</p> <p>PROPRIETARY NOTICE THIS DOCUMENT CONTAINS CONFIDENTIAL AND TRADE SECRET INFORMATION. IT IS THE PROPERTY OF DASSI CAR WASH SYSTEMS AND IS LOANED TO YOU FOR YOUR USE ONLY. IT IS NOT TO BE REPRODUCED, COPIED, DISTRIBUTED, OR USED IN ANY MANNER WITHOUT THE WRITTEN PERMISSION OF DASSI CAR WASH SYSTEMS. IT WILL BE RETURNED TO DASSI CAR WASH SYSTEMS UPON COMPLETION OF THE PROJECT FOR WHICH IT WAS LOANED TO YOU. YOU ARE NOT TO DISCLOSE THE CONTENTS OF THIS DOCUMENT TO ANY OTHER PERSON OR ENTITY. YOU ARE TO MAINTAIN THE CONFIDENTIALITY OF THIS INFORMATION AND TO TAKE ALL NECESSARY PRECAUTIONS TO PROTECT IT FROM UNAUTHORIZED DISCLOSURE. YOU ARE TO RETURN THIS DOCUMENT TO DASSI CAR WASH SYSTEMS UPON COMPLETION OF THE PROJECT FOR WHICH IT WAS LOANED TO YOU.</p> <p>MATERIAL SH - SST 409-2D - 11GA</p> <p>FINISH 15.33 X 23.69</p> <p>HEAT TREAT N/A</p> <p>SURFACE TREATMENT N/A</p>	<p>1999 EAST 12TH STREET GALENA, KS 66739 TEL: (620) 763-5355 FAX: (620) 763-5725 www.dassicarwashsystems.com</p>
<p>COMPANY: HYDRAULIC LINE CONNECTIONS</p> <p>PROJECT: XP-215.00.00</p> <p>ASSEMBLY</p>			
SCALE: N/A	DRAWN BY: JUH	DATE: 09/22/2005	REV: N/A

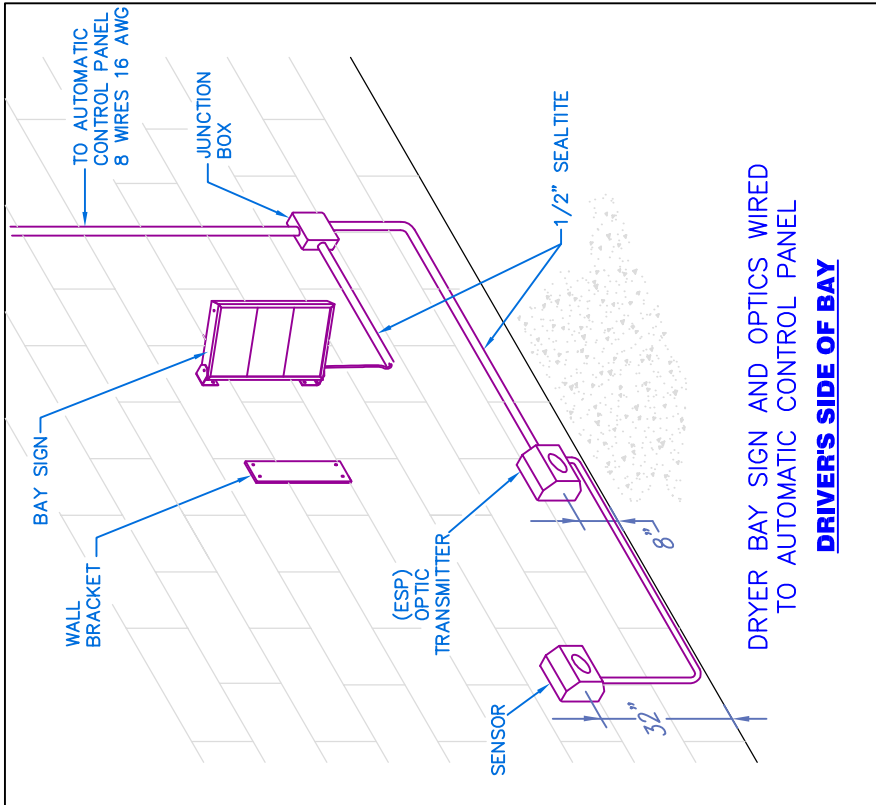

DRIVER BAY SIGN AND OPTICS WIRED TO AUTOMATIC CONTROL PANEL

DRIVER'S SIDE OF BAY

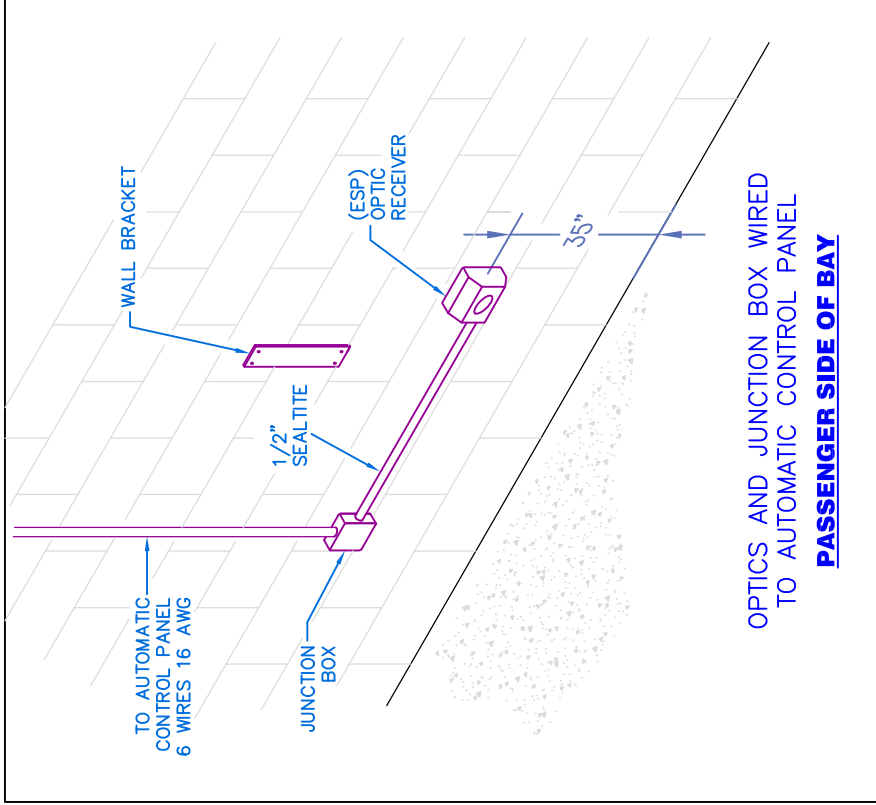

OPTICS AND JUNCTION BOX WIRED TO AUTOMATIC CONTROL PANEL

PASSENGER SIDE OF BAY

XP

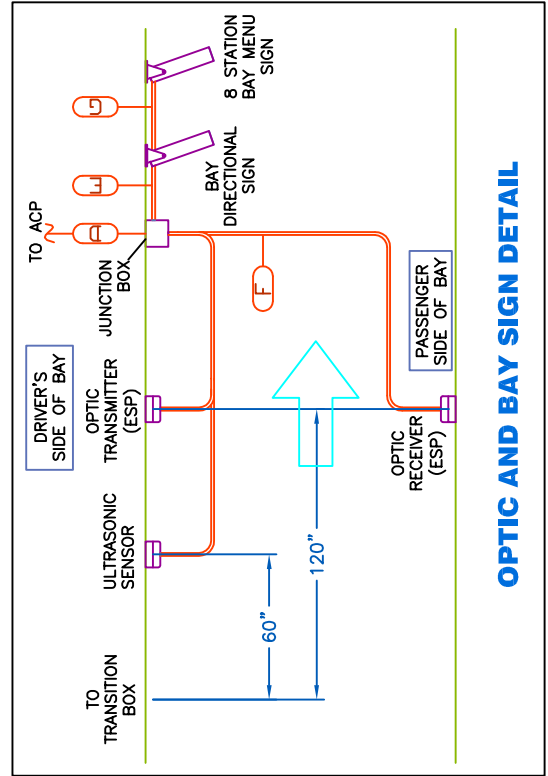

REV	DESCRIPTION	DATE

ESP BAY WIRING

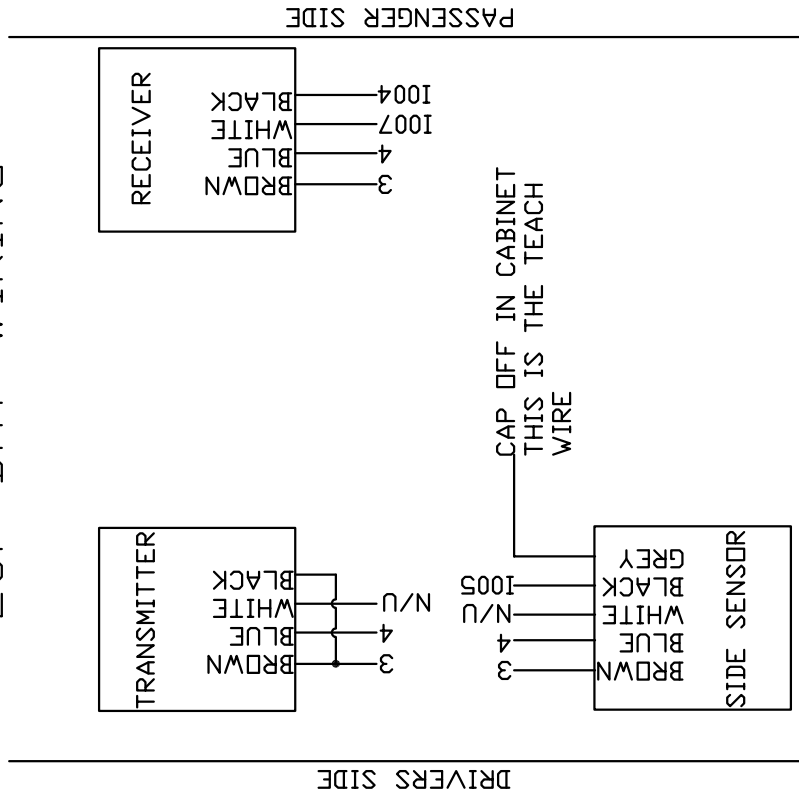

REV	DESCRIPTION	DATE	APPROVALS	DATE	STANDARD	TOLERANCES	REVISIONS	DATE	DESCRIPTION
N/A	N/A	N/A	N/A	N/A	N/A	N/A	N/A	N/A	N/A
JJH	JJH	06/18/08	JJH	06/18/08	ASME Y14.5	±0.000	±0.000	±0.000	±0.000
JJH	JJH	06/18/08	JJH	06/18/08	ASME Y14.5	±0.000	±0.000	±0.000	±0.000
JJH	JJH	06/18/08	JJH	06/18/08	ASME Y14.5	±0.000	±0.000	±0.000	±0.000
N/A	N/A	N/A	N/A	N/A	N/A	N/A	N/A	N/A	N/A
N/A	N/A	N/A	N/A	N/A	N/A	N/A	N/A	N/A	N/A

REVISIONS	DATE	DESCRIPTION

DATE	06/18/08
TIME	10:47:00
USER	JJH
PROJECT	ESP SENSOR WIRING SCHEMATIC
FILE	XPMS0100
DESCRIPTION	ESP SENSOR WIRING SCHEMATIC

1 2 3 4 5 6 7 8

ITEM NO.	PART NUMBER	DESCRIPTION	QTY.
1	B-12466	BRKT WALL MOUNT FOR ESP COVER	1
2	A-12470	CONDUIT SNAP-STRAP .750 PVC CARLON E978EC-CAR	4
3	B-12468	COVER ESP ULTRA SONIC COVER	1
4	B-12471	CONDUIT PVC .750 X 11.00 SCH 40 CARLON	1
5	SCREW SST 10 X .75	SCR SHT MTL SST PHILLIPS #10 X 0.750	8
6	SCREW SST 10 X 1.5	SCR SHT MTL SST PHILLIPS #10 X 1.5	2
7	SCR HHCS 5MMX2.5	HEX HEAD CAP SCREW SST 5MM X 2.5"	2
8	NUT 5M-8	NUT HEX 5MM-8	2
9	WASHER 5M	WASHER SST 5MM	2
10	A-10160	OPTICS HTD RCVR LSE 96M/P-3012-41	1

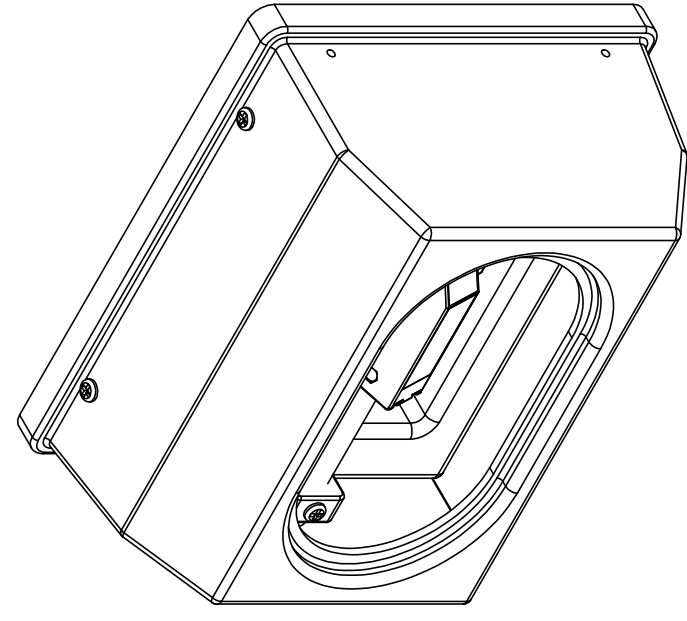
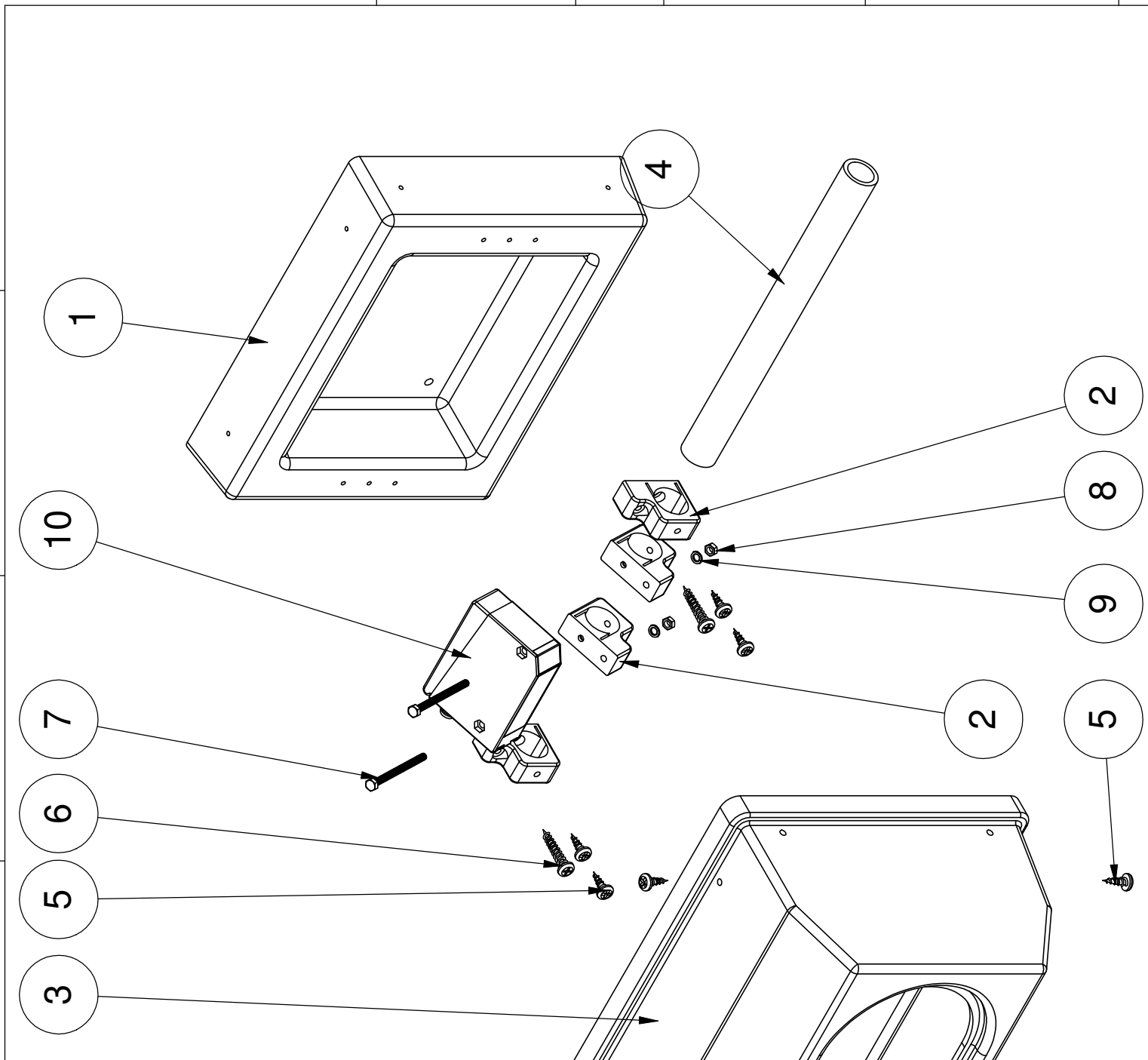

COPYRIGHT © 1995
OASIS CAR WASH SYSTEMS
ALL RIGHTS RESERVED

STANDARD TOLERANCES

X.X	= ± 0.063
X.XX	= ± 0.015
X.XXX	= ± 0.005
ANGLE	= ± 0°30'
FLATNESS	= 0.05/FT

WARNING!
THE EXPORT OR REEXPORT OF THIS DRAWING OR A PRODUCT PRODUCED BY THIS DRAWING IS SUBJECT TO U.S. EXPORT ADMINISTRATION REGULATIONS AND OTHER APPLICABLE GOVERNMENTAL RESTRICTIONS OR REGULATIONS.

DIMENSIONS IN [] ARE MILLIMETERS
UNLESS OTHERWISE NOTED BREAK ALL SHARP EDGES AND CORNERS .015 AND 64 μIN SURFACE FINISH ALL OVER

PROPRIETARY NOTICE

THIS DOCUMENT CONTAINS CONFIDENTIAL AND TRADE SECRET INFORMATION. IS THE PROPERTY OF OASIS CAR WASH SYSTEMS, AND IS GIVEN TO THE RECEIVER IN CONFIDENCE. THE RECEIVER BY RECEIPT AND RETENTION OF THE DOCUMENT ACCEPTS THE DOCUMENT IN CONFIDENCE AND AGREES THAT, EXCEPT AS AUTHORIZED IN WRITING BY OASIS CAR WASH SYSTEMS, IT WILL (1) NOT USE THE DOCUMENT OR ANY COPY THEREOF OF THE CONFIDENTIAL OR THE TRADE SECRET INFORMATION THEREIN; (2) NOT COPY THE DOCUMENT; (3) NOT DISCLOSE TO OTHERS EITHER THE DOCUMENT OR THE CONFIDENTIAL OR TRADE SECRET INFORMATION THEREIN; AND (4) UPON COMPLETION OF THE NEED TO RETAIN THE DOCUMENT, OR UPON DEMAND, RETURN THE DOCUMENT, ALL COPIES THEREOF, AND ALL MATERIAL COPIED THEREFROM.

MATERIAL	LISTED
MATERIAL NO.	LISTED
HEAT TREAT	N/A
ASSEMBLY	F-12577

SIZE	LISTED
SURFACE	N/A

1909 EAST 12th STREET
GALENA, KS 66739
TEL: (800) 892-3537
TEL: (620) 783-1355
FAX: (620) 783-5735
www.oasiscarwashsystems.com

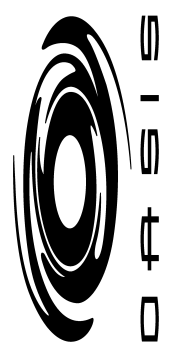

COMPONENT
ESP OPTIC RECEIVER ASSEMBLY XP

QTY/ASSY	N/A	DWG NO	B-12580	REV	A-01
SCALE	1:4	BY	JJH	DATE	7/1/2008
		SHT	1	OF	1

REV A-01

DWG NO. B-12580

1 2 3 4 5 6 7 8

ITEM NO.	PART NUMBER	DESCRIPTION	QTY.
1	B-12466	BRKT WALL MOUNT FOR ESP COVER	1
2	A-12470	CONDUIT SNAP-STRAP .750 PVC CARLON E978EC-CAR	4
3	B-12468	COVER ESP ULTRA SONIC COVER	1
4	B-12471	CONDUIT PVC .750 X 11.00 SCH 40 CARLON	1
5	SCREW SST 10 X .75	SCR SHT MTL SST PHILLIPS #10 X 0.750	8
6	SCREW SST 10 X 1.5	SCR SHT MTL SST PHILLIPS #10 X 1.5	2
7	SCR HHCS 5MMX2.5	HEX HEAD CAP SCREW SST 5MM X 2.5"	2
8	NUT 5M-8	NUT HEX 5MM-8	2
9	WASHER 5M	WASHER SST 5MM	2
10	A-10161	OPTICS HTD XMTR LSS 96M-1090-43	1

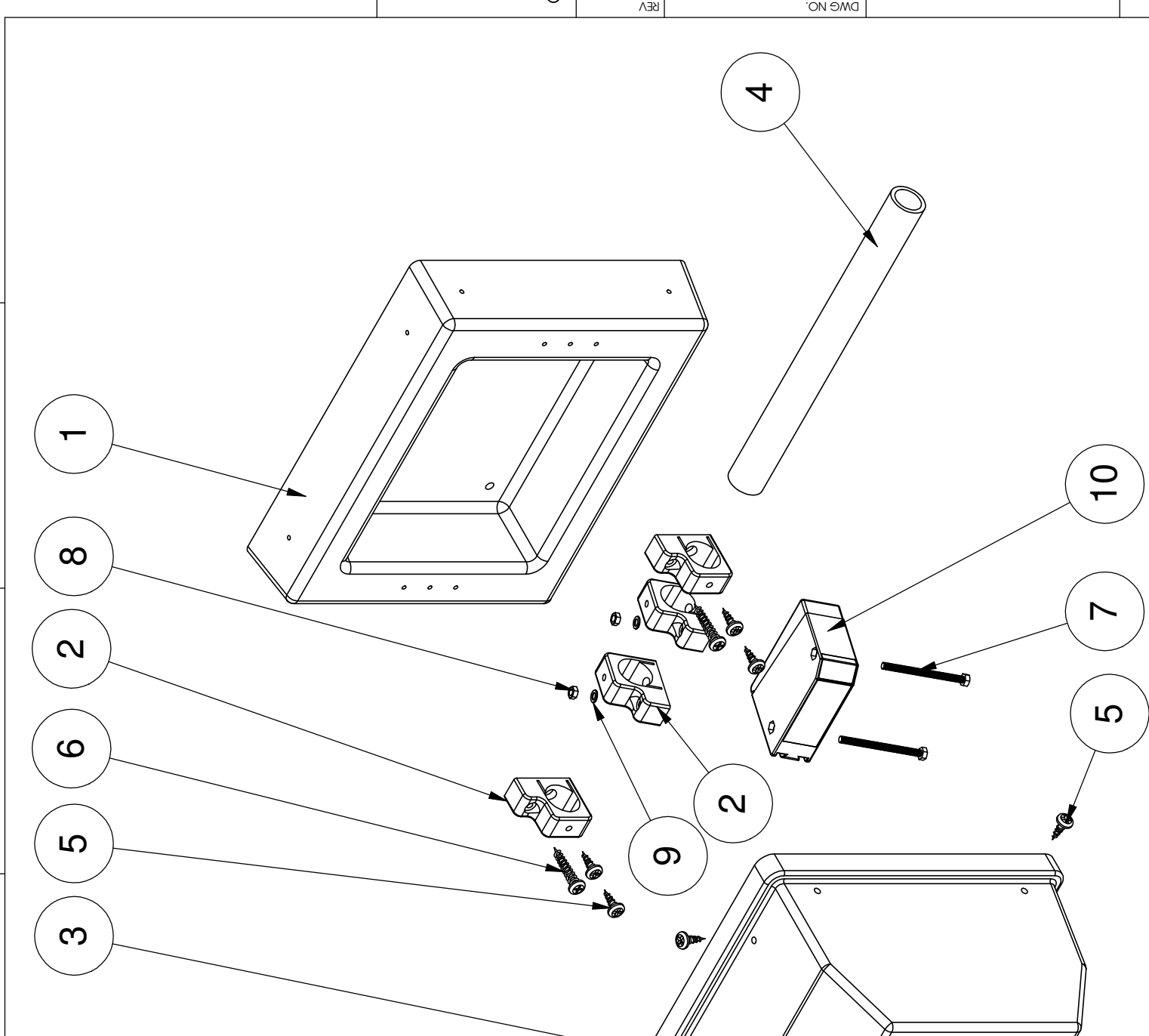

REV.	DESCRIPTION	DATE	APVD
	REVISIONS		

DIMENSIONS IN [] ARE MILLIMETERS UNLESS OTHERWISE NOTED BREAK ALL SHARP EDGES AND CORNERS .015 AND 64 μIN SURFACE FINISH ALL OVER	
PROPRIETARY NOTICE THIS DOCUMENT CONTAINS CONFIDENTIAL AND TRADE SECRET INFORMATION. IS THE PROPERTY OF OASIS CAR WASH SYSTEMS, AND IS GIVEN TO THE RECEIVER IN CONFIDENCE. THE RECEIVER BY RECEIVING AND RETENTION OF THE DOCUMENT ACCEPTS THE DOCUMENT IN CONFIDENCE AND AGREES THAT, EXCEPT AS AUTHORIZED IN WRITING BY OASIS CAR WASH SYSTEMS, IT WILL (1) NOT USE THE DOCUMENT OR ANY COPY THEREOF OF THE CONFIDENTIAL OR THE TRADE SECRET INFORMATION THEREIN; (2) NOT COPY THE DOCUMENT; (3) NOT DISCLOSE TO OTHERS EITHER THE DOCUMENT OR THE CONFIDENTIAL OR TRADE SECRET INFORMATION THEREIN; AND (4) UPON COMPLETION OF THE NEED TO RETAIN THE DOCUMENT, OR UPON DEMAND, RETURN THE DOCUMENT, ALL COPIES THEREOF, AND ALL MATERIAL COPIED THEREFROM.	
MATERIAL	LISTED
MATERIAL NO.	LISTED
HEAT TREAT	N/A
ASSEMBLY	F-12577
SIZE	LISTED
SURFACE	N/A



1909 EAST 12th STREET
 GALENA, KS 66739
 TEL: (620) 892-3537
 TEL: (620) 783-1355
 FAX: (620) 783-5735
 www.oasiscarwashsystems.com

COMPONENT

ESP OPTIC TRANSMITTER ASSEMBLY XP

QTY/ASSY	N/A	DWG NO	B-12581	REV	A-01
SCALE	1:4	BY	JJH	DATE	7/1/2008
		SHT	1	OF	1

1 2 3 4 5 6 7 8

ITEM NO.	PART NUMBER	DESCRIPTION	QTY.
1	B-12466	BRKT WALL MOUNT FOR ESP COVER	1
2	B-12468	COVER ESP ULTRA SONIC COVER	1
3	SCREW SST 10 X .75	SCR SHT MTL SST PHILLIPS #10 X 0.750	8
4	B-12584	BRKT ESP ULTRASONIC SENSOR MOUNT	1
5	A-12338	N/A	1
6	scr skt hd cap .250-28 x 1	N/A	2

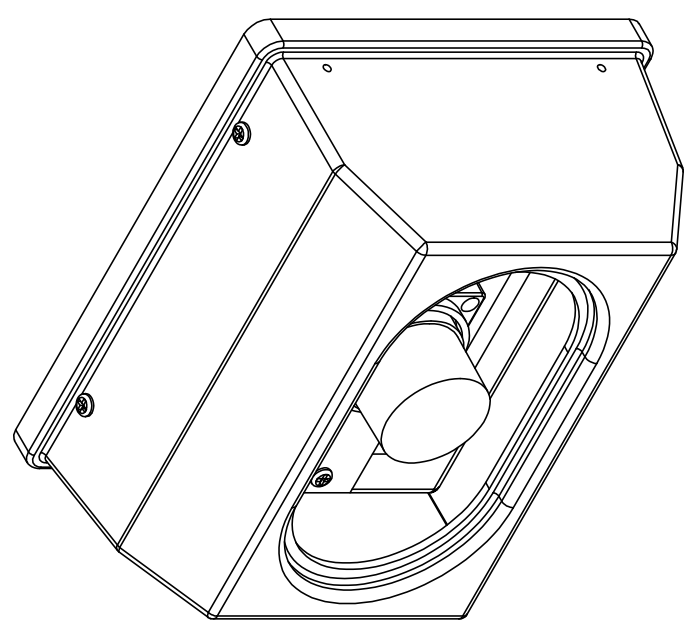
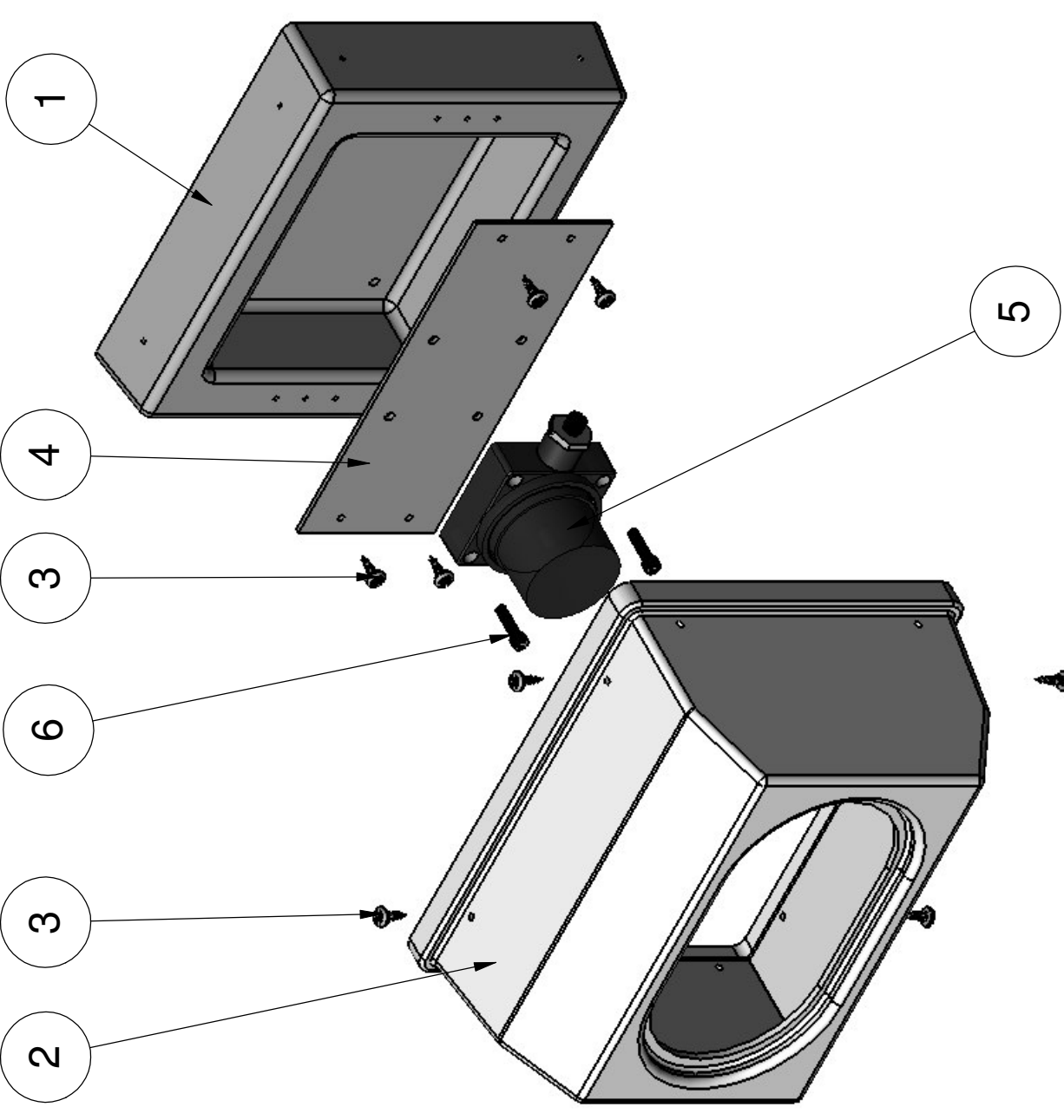

D C B A

REV A-01
DWG NO. B-12473

COPYRIGHT © 1995
OASIS CAR WASH SYSTEMS
ALL RIGHTS RESERVED

STANDARD TOLERANCES
 X.X = ± 0.063
 X.XX = ± 0.015
 X.XXX = ± 0.005
 ANGLE = ± 0°30'
 FLATNESS = 0.05/FT

WARNING!
 THE EXPORT OR REEXPORT OF THIS DRAWING OR A PRODUCT PRODUCED BY THIS DRAWING IS SUBJECT TO U.S. EXPORT ADMINISTRATION REGULATIONS AND OTHER APPLICABLE GOVERNMENTAL RESTRICTIONS OR REGULATIONS.

DIMENSIONS IN [] ARE MILLIMETERS

UNLESS OTHERWISE NOTED BREAK ALL SHARP EDGES AND CORNERS .015 AND 64 μIN SURFACE FINISH ALL OVER

PROPRIETARY NOTICE
 THIS DOCUMENT CONTAINS CONFIDENTIAL AND TRADE SECRET INFORMATION. IS THE PROPERTY OF OASIS CAR WASH SYSTEMS, AND IS GIVEN TO THE RECEIVER IN CONFIDENCE. THE RECEIVER BY RECEIPT AND RETENTION OF THE DOCUMENT ACCEPTS THE DOCUMENT IN CONFIDENCE AND AGREES THAT, EXCEPT AS AUTHORIZED IN WRITING BY OASIS CAR WASH SYSTEMS, IT WILL (1) NOT USE THE DOCUMENT OR ANY COPY THEREOF OF THE CONFIDENTIAL OR THE TRADE SECRET INFORMATION THEREIN; (2) NOT COPY THE DOCUMENT; (3) NOT DISCLOSE TO OTHERS EITHER THE DOCUMENT OR THE CONFIDENTIAL OR TRADE SECRET INFORMATION THEREIN; AND (4) UPON COMPLETION OF THE NEED TO RETAIN THE DOCUMENT, OR UPON DEMAND, RETURN THE DOCUMENT, ALL COPIES THEREOF, AND ALL MATERIAL COPIED THEREFROM.

MATERIAL LISTED

MATERIAL NO. LISTED SIZE LISTED

HEAT TREAT N/A SURFACE N/A

ASSEMBLY F-12577/F-12339

OASIS

1909 EAST 12th STREET
 GALENA, KS 66739
 TEL: (620) 892-3537
 TEL: (620) 783-1355
 FAX: (620) 783-5735
 www.oasiscarwashsystems.com

COMPONENT
ESP ULTRA SONIC ASSEMBLY

QTY/ASSY N/A
 SCALE 1:4

DWG NO **B-12473**
 REV **A-01**

BY **JJH** DATE **7/1/2008**
 SHT **1** OF **1**

REV.	DESCRIPTION	DATE	APVD
	REVISIONS		

99

